

SNAP END CAP

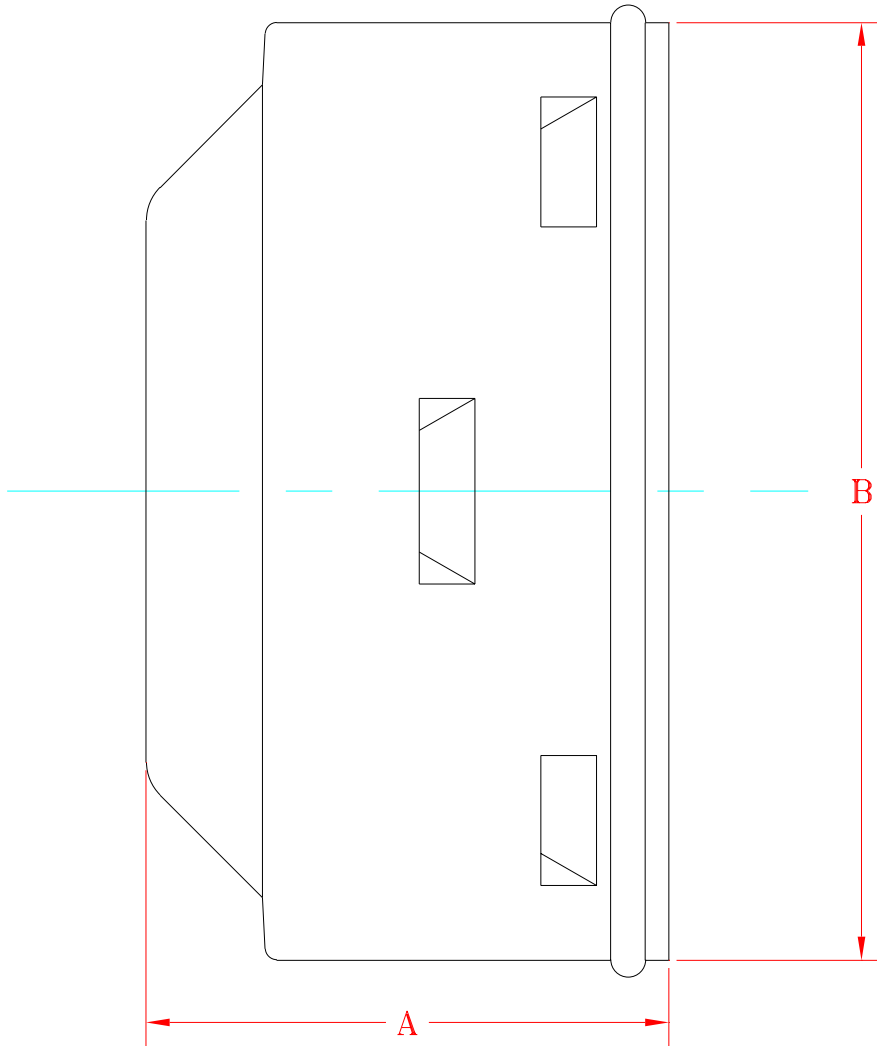

PART N ^o	PIPE SIZE	A	B
0332-AA	3" 75 mm	1.875" 48 mm	4" 101 mm
0432-AA	4" 100 mm	2.75" 70 mm	5.125" 130 mm
0832-AA	8" 200 mm	4.25" 108 mm	9.875" 251 mm
1032-AA	10" 250 mm	5" 127 mm	12.5" 318 mm



REVISIONS

BY	DATE

NOTE: ALL DIMENSIONS ARE NOMINAL

DRAWN BY
M.D.S. 6-10-95

APPROVED BY
N.E.K. 6-10-95

DRAWING #
SW-151